

STEVENAGE BOROUGH COUNCIL

ROAD TRAFFIC REGULATION ACT 1984

**THE BOROUGH OF STEVENAGE (STEVENAGE) (OFF-STREET PARKING PLACES) ORDER
2023**

Stevenage Borough Council, pursuant to the arrangements made under Section 19 of the Local Government Act 2000 and the Local Government (Arrangements for Discharge of Functions) (England) Regulations 2000 with Hertfordshire County Council in exercise of their powers under Sections 32, 33, 34, 35, 35A-C, 44, 45, 46, 46A, 47, 49 and 53 of the Road Traffic Regulation Act 1984, (hereinafter referred to as "the Act of 1984"), and Parts III-IV of Schedule 9 of the Act 1984 and of all other enabling powers and after consultation with the Chief Officer of Police in accordance, hereby makes the following Order:-

PART I - GENERAL

1. Commencement & Citation

- a) This Order may be cited as "The Borough of Stevenage (Stevenage) (Off-Street Parking Places) Order 2023" and shall come into operation on 5th May 2023.
- b) The Borough of Stevenage (Stevenage) (Off-Street Parking Places) Order 2023 plans (hereinafter referred as "off street plans") listed in Schedule 1 of this Order and identified as TPE/03/22-9/01, TPE/03/22-9/02, TPE/03/22-9/03, TPE/03/22-9/04, TPE/03/22-9/05, TPE/03/22-9/06, inclusive of their keys are incorporated into this Order.

2. Revocations

- a) This Order amends The Borough of Stevenage (Town Centre) (Off-Street Parking Places) Order 2008 only in so far as they are affected by the restrictions imposed by this Order.

3. Interpretation

- a) The Interpretation Act 1978 shall apply for the interpretation of this Order as it applies for the interpretation of an Act of Parliament.
- b) Save as otherwise defined within this Order each and every expression shall have the meaning assigned to it by the Traffic Signs regulations and General Directions 2016, SI No.362.
- c) Any reference in this Order to any enactment shall be construed as a reference to that enactment as amended by any subsequent enactment.
- d) In this Order, except where the context otherwise requires, the following expressions have the meaning hereby respectively assigned to them:

"the off street plans" means The Borough of Stevenage (Stevenage) (Off-street Parking Places) Order 2023 Plans including their keys and the schedules, and listed in Schedule 1 of this Order which are incorporated into this Order pursuant to Article 1(b) hereof;

"Act of 1984" means the Road Traffic Regulation Act 1984;

"ANPR" means the Automatic Number Plate Recognition technology provided by the Council;

"Approved method of payment" means payment by credit, debit, pre-paid or any other electronic card or any other type of payment through a scheme organised by the Council;

"bay markings" means any lines marked on the surface of a parking place to indicate the limits of each individual parking bay;

"Charging Days and Hours" in relation to a parking place means the period during which a charge for parking is made as specified in Schedule 2 of this Order.

"Civil Enforcement Officer" means a Civil Enforcement Officer appointed by Stevenage Borough Council under Section 76 of the Act of 2004;

"Council" means Stevenage Borough Council and includes any parking services contractor or authorised agent appointed by or acting on behalf of the Council for the purpose of any function under the provisions of this order;

"Delivering" and **"Collecting"** in relation to any goods include checking the goods for the purpose of their delivery or collection;

"Disabled Parking Bay" means an area contained within a Parking Place marked by white road markings to indicate the position in which a vehicle may be parked, for use by a disabled person's vehicle displaying in the relevant position a disabled persons badge

"Disabled Person's Badge" and **"Parking Disc"** have the same meaning as in the Local Authorities Traffic Orders (Exemption for Disabled Persons) (England) Regulations 2000

"Disabled Person's Vehicle" means a Vehicle lawfully displaying a Disabled Person's Badge and is a Vehicle which, immediately before or after any period of waiting allowed by virtue of a provision of a kind required by Regulation 8 of the Local Authorities' Traffic Orders (Exemptions for Disabled Persons) (England) Regulations 2000 SI 683, has been or is to be driven by a Disabled Person or, as the case may be, has been or is to be used for carrying Disabled Persons as passengers;

"Driver" means the person driving or having control or charge of the Vehicle at any given time and in particular in relation to a Vehicle waiting in a Parking Place the person driving at the time it was left in that Parking Place;

"Electric Vehicle" means a vehicle which uses electricity as a source of power for propulsion which is derived from an electric storage battery which is not connected by an exterior charging lead to any power source whilst the vehicle is in motion and includes a vehicle which in addition uses, or is capable of using, other sources of power for propulsion;

"Electric Vehicle Charging Bay" means an area contained within a Parking Place delineated by painted road markings to indicate the marked limits of the bay and the position in which an Electric Vehicle may be parked and as identified in the key and shown in "the off street plans" and identified in the keys to those plans;

"Goods" means goods or burden of any description and includes postal packets of any description;

"Key" means the Key attached to "the off street plans" to be read in conjunction with those plans;

"Motorcycle Parking Bay" means an area contained within a Parking Place delineated by painted road markings to indicate the marked limits of the bay and the position in which a MotorCycle may be parked and as shown in "the off street plans" and identified in the keys to those plans;

"Motorcycle" has the meaning as given by Section 136(4) of the Act of 1984;

"Motor Vehicle" has the meaning as given by Section 136(1) of the Act of 1984;

"Operational Days and Hours" in relation to a car park means the period during which the car park open for use by the public as specified in Schedule 2;

"Owner" has the meaning assigned to it by s.82 (2) and (3) of the Road Traffic Act 1991;

"Parking Bay" means an area contained within a Parking Place delineated by painted road markings to indicate the marked limits of the Parking Bay and the position in which a Vehicle or Vehicle of any specified class may be parked and as "the off street plans" and identified in the keys to those plans;

"Parking Place" means an area of land or building, where vehicles, or vehicles of a specified class, may wait within Parking Bays marked out for the purpose as set out in s.32(4)(b) of the 1984 Act and as shown "the off street plans" and identified in the keys to those plans.

"Passenger Vehicle" means a motor vehicle constructed solely for the carriage of passengers and their effects and adapted to carry not more than sixteen passengers exclusive of the Driver, and not drawing a trailer;

"Payment Machine" means an apparatus to indicate the time of expiry, the payment of the initial charge and the periods in respect of which the charge has been paid.

"entry ticket" means any parking device either card, disc, token, chip coin or other similar device;

"Payment card" means a bank credit or debit card, e-purse card, discount card, or pre-payment card to be used where such facility is advertised and provided in a parking place;

"penalty charge" shall have the same meaning as a charge set by the Council in accordance with The Civil Enforcement of Road Traffic Contraventions (Approved Devices, Charging Guidelines and General Provisions) (England) Regulations 2022 and the provisions of Part 6 and Schedule 9 of The Traffic Management Act 2004;

"penalty charge notice" shall mean a notice issued by a Civil Enforcement Officer in accordance with The Civil Enforcement of Road Traffic Contraventions (Approved Devices, Charging Guidelines and General Provisions) (England) Regulations 2022 and the provisions of Part 6 and Schedule 9 of The Traffic Management Act 2004;

"season ticket" means any parking device such as card, disc, token or other similar device validated by the Council or a person authorized in behalf of the Council and issued under the terms of this Order;

"season ticket holder" means a person to whom a season ticket has been issued;

"Plug in - Electric Hybrid Vehicle" is a vehicle equipped with an electric traction system which is powered by an electric storage battery which is not connected by an exterior recharging lead to any power source whilst the vehicle is in motion and includes a vehicle which in addition uses at least another energy source for traction purposes.

"Recharging Post" means a device designed for the recharging of electric vehicles or plug in electric hybrid vehicles;

"Recharging Lead" means a device designed for connecting the recharging post to an electric vehicle or plug in electric hybrid vehicle;

"Charging Device" means an installation adjacent to a parking place for the purposes of recharging the batteries of an electric vehicle or hybrid vehicle by means of a connecting lead;

"Relevant Position" means on the dashboard or fascia of the Vehicle or where the Vehicle is not fitted with a dashboard or fascia in a conspicuous position on the Vehicle as described in the Disabled Persons (Badges for Motor Vehicles) (Amendment) Regulations 2000 SI 682;

"Restricted area" means an area within the parking place boundaries as shown in the relevant plans to this Order that is not marked as a parking bays, e.g. access road, turning area, grassed areas, raised or lowered kerb or areas of landscaping;

"Road" means any length of highway or of any other road to which the public has access, and includes bridges over which a road passes as set out in s142 (1) of the 1984 Act;

"Service Provider" is a service administering parking transactions, records of season tickets and records of paperless entry or season tickets;

"Staff" means any person employed by Stevenage Borough Council and includes any parking services contractor or authorised agent appointed by or acting on behalf of the Council for the purpose of any function under the provisions of this Order;

"Traffic Sign" means a device or object as prescribed or authorised under, or having effect as though prescribed or authorised under Section 64 of the Act of 1984;

"Universal Service Provider", "Provision of a universal Postal Service" and "Postal Packet" shall bear the same meaning as in the Postal Services Act 2011.

Installation of payment machines

4. The Council shall install and maintain a payment machine or payment machines in each parking place in such position or positions as they think fit.

PART II – DESIGNATION OF PARKING PLACES AND PARKING BAYS

5. Each area as shown on the Off-Street Plans and indicated in the keys to those plans as a parking place is authorized as a parking place and may be used subject to the conditions and restrictions imposed by this Order for the parking of motor vehicles.
6. Within a parking place no person shall, cause or permit any motor vehicle to wait at any time in any part of the parking place unless that vehicle is waiting wholly parked within the marked limits of a parking bay as shown on "the Off-Street Plans" and indicated in the Keys to those plans.
7. Within a parking place no person shall, cause or permit any motor vehicle to wait at any time in a disabled parking bay as shown on "the Off-Street Plans" and indicated in the keys to those plans unless it is a disabled persons vehicle on which is displayed in the relevant position a valid disabled person's badge.
8. Within a parking place no person shall, cause or permit any motor vehicle to wait at any time in a motorcycle parking bay as shown on "the Off-Street Plans" and indicated in the keys to those plans unless it is a motorcycle.

9. Within a parking place no person shall, cause or permit any motor vehicle to wait at any time in an electric vehicle bay as shown on "the Off-Street Plans" and indicated in the keys to those plans unless it is;
- a) An electric vehicle or plug in electric hybrid vehicle; and
 - b) The electric vehicle or plug in electric hybrid vehicle is connected to the recharging post and actively recharging via the recharging lead.

Application for and Issue of Season Tickets for use in Parking Places

- 10.
- a) Application for a Season Ticket will be made on a paper form or electronic application form issued by and obtainable from the Council. The form must be completed and returned accompanied by a payment for the charge set by the Council and by such documentary evidence of entitlement in respect of an application for a Season Ticket made to them as the Council may reasonably request to verify any particulars or information given to them.
 - (b) On receipt of a properly completed application and fee where appropriate the Council shall issue to the appropriate applicant a Season Ticket provided that the applicant qualifies for the Season Ticket.
 - (c) Where a Season Ticket is issued to any person upon receipt of a cheque or credit/debit card details and the payment is subsequently dishonored, the Season Ticket shall immediately cease to be valid.
 - (d) The Council will serve notice by recorded delivery on the person to whom the Season Ticket was issued at the address shown by the applicant on the application form or at any other address believed to be the applicant's place of abode, requiring that person to surrender the Season Ticket, to the Council within 48 hours of the receipt of the notice.
11. The issue of a season ticket does not entitle the season ticket holder's vehicle to a reserved parking bay, nor can a parking bay be guaranteed.
12. If a driver is the holder of a valid Season Ticket issued by the Council, they shall hold the season ticket up to the season ticket acceptance machine at the entrance / exit to the parking place. This will raise the barrier allowing the vehicle to enter / leave.

Charges for Season Tickets

13. The charges for Season Tickets are shown in Schedule 2 to this Order but may be amended by the Council giving notice in accordance with section 35C of the Act of 1984.
14. The Council may at their discretion issue season tickets available for use at one or more named parking places to persons holding "disabled persons badges" issued under Regulation 5(d) of the Disabled Persons Badges for Motor Vehicles 1982 and reside in the administrative area of Stevenage Borough Council subject to charges shown in Schedule 2.

Surrender, Withdrawal and Validity of a Season Ticket

15. a) A Season Ticket Holder may surrender a Season Ticket to the Council at any time.
- (b) The Council may by notice served by recorded delivery on the Season Ticket holder at the address shown by that person on the application form or at any other address believed to be that person's place of abode, withdraw a Season Ticket, if it appears to the Council that:

- i) the vehicle in respect of which a Season Ticket was issued has been adapted or used in such a manner that it is no longer a vehicle for which a Season Ticket can be issued;
- ii) the details of the Season Ticket holder have changed and no longer meets the eligibility criteria.

(c) A Season Ticket shall cease to be valid at midnight on the specified expiry date or on the date the Council withdraws the Season Ticket by notice, whichever is the earlier.

(d) The Council will not make any refund for the withdrawal of a Season Ticket.

(e) The Council will refund part of the cost of a Season Ticket which has been surrendered, if not less than one month before the expiry date, the amount of refund subject to administration charge as specified in Schedule 2 of this Order.

Application for and the issue of a Duplicate Season Ticket

16. The Council will issue a duplicate or replacement Season Ticket in the following circumstances:

- a) If a Season Ticket is damaged and cannot be used, the Permit Holder shall surrender it to the Council. If the Season Ticket is accompanied by an application for a replacement Season Ticket and the Council is satisfied as to destruction of the Season Ticket, a duplicate Season Ticket shall be issued subject to charges specified in Schedule 2 of this Order and the original Season Ticket shall become invalid.
- b) If a paper Season Ticket is lost, the Season Ticket Holder may apply to the Council for the issue of a duplicate. If the Council is satisfied as to the loss of the Season Ticket, a duplicate will be issued subject to charges specified in Schedule 2 of this Order. The lost Season Ticket shall become invalid.
- c) The Council will make an administration charge for the issue of a duplicate Season Ticket as shown in Schedule 2 to this Order.

Amount of Initial charge for parking places

17. The initial charge for a vehicle (other than a vehicle otherwise exempted by this Order) left in a parking place during the charging day and hours shall be as specified in Schedule 2 of this Order. The amount of the initial charge may be varied in future by a notice of variation under section 35C of the Act of 1984.

18. When parking durations span more than one of the periods set out in Schedule 2 of this Order an appropriate combined charge may apply.

Payment of the initial charge in connection with the use of parking places

19. If a driver of a vehicle (other than a vehicle otherwise exempted by this Order) is not a season ticket holder they shall gain access to the car park after the ANPR system present at the entrance to the parking place will register the vehicle details and time of entry. This will then raise the barrier to allow vehicle entry.

20. When the driver wishes to leave the parking place, before returning to their vehicle they must insert their vehicle registration number on the payment machines who will indicate the value of the charge for the period between the time of entry and the time of departure. The driver must then make payment following the instructions thereon and by using an approved method of payment.

21. Upon receipt of the value of the charge so prescribed the payment machine will record the payment and the driver must then within fifteen minutes drive the vehicle to the exit barrier. The ANPR system will raise the barrier allowing the vehicle to exit the car park.
22. Where the ANPR system fails to raise the exit barrier because the driver of the vehicle has failed to drive to the exit barrier within fifteen minutes after making the payment, the driver shall return to the payment machine and repeat the procedures in Articles 20-22.
23. No refund shall be payable by the Council in respect of the initial charge but may be given at the discretion of the Council.

Payment to recoup electricity costs

24. The Charging Device may apply a monetary fee for the use of electricity at any time. This is not and shall not be considered a fee for parking and may be set and varied by the Council from time to time, subject to such caps and limits as may be set by primary and secondary legislation.

Power to suspend use of Parking Place

25. Any person authorised by the Council may suspend the use of a parking place or parking bay whenever he considers such suspension reasonably necessary:
 - (a) for the purpose of facilitating the movement of traffic or promoting its safety;
 - (b) for the purpose of any building operation, demolition or excavation in or adjacent to the parking place or the maintenance, improvement or reconstruction of the parking place or the laying, erection, alteration, removal or repair in or adjacent to the parking place of any sewer or of any main, pipe or apparatus for the supply of gas, water or electricity or of any telecommunication apparatus or traffic sign; or
 - (c) for the convenience of occupiers of premises adjacent to the parking place on any occasion for the removal of furniture from one office or dwelling house to another place; or
 - (d) on any occasion on which it is likely by reason of some special attraction that any street will be thronged or obstructed; or
 - (e) for the convenience of occupiers of premises adjacent to the parking place at times of weddings or funerals or on other special occasions; or
 - (f) for the purpose of facilitating the cleansing of the parking place.

Restrictions on the use of a parking place

26. a) During the operational hours no person shall use any parking place or any vehicle while it is in a parking place in connection with the sale or offering or exposing for sale of any goods to any person in or near the parking place or in connection with the selling of offering for sale of his skill in handicraft or his services in any other capacity.
- (b) Provided that nothing in this Article shall prevent the sale of goods from a vehicle:
 - (i) if the vehicle is a passenger vehicle, a goods carrying vehicle, a motorcycle, or an invalid carriage and the goods are immediately delivered at or taken into premises adjacent to the vehicle from which the sale is effected; or
 - (ii) Car valeting may be exempt if approved in writing by the Parking Manager.

(c) During the operational hours no person shall use any parking place in connection with the sale or offering or exposing for sale any vehicle.

27. No person shall use any part of a parking place or any vehicle left in a parking place:

- (a) for sleeping, camping, cooking or eating;
- (b) for the purpose of servicing or washing any vehicle or part thereof other than is reasonably necessary to enable that vehicle to depart from the parking place unless authorised in writing by the Parking Manager.

28. In a parking place no person shall:

- (a) erect or permit to be erected any tent, booth, or other structure without written consent of the Council; or
- (b) light of cause or permit to be lit any fire;
- (c) wantonly shout or otherwise make any loud noise to the disturbance or annoyance of users of the parking places or residents or premises in the neighbourhood;
- (d) engage in pedal cycling, skateboarding, roller-skating, ball games, or games of any description unless authorised by the Council in writing;
- (e) except with the permission of the Council, drive any vehicle in a Parking Place other than for the purpose of leaving that vehicle in that Parking Place in accordance with the provisions of this Order or for the purpose of departing from that Parking Place.

Exemptions to the provisions of this Order

29. Notwithstanding the foregoing provisions of this Order any vehicle may wait in any part of a parking place not being a marked parking bay if:

- (a) The vehicle is waiting for as long as may be reasonably necessary to enable a person to board or alight from the vehicle or load thereon or unload there from the vehicle occupant's personal luggage and that activity is taking place at the vehicle;
- (b) The vehicle is waiting owing to the driver being prevented from proceeding by circumstances beyond his control or such waiting is necessary in order to avoid an accident;
- (c) The vehicle is being used for fire brigade, ambulance or police purposes, or, not being a passenger vehicle, is being used in the service of a local authority in pursuance of statutory powers or duties provided that in all the circumstances it is reasonably necessary for such duties for the vehicle to wait in the place in which it is waiting;
- (d) The vehicle is waiting only for so long as may be necessary to enable it to be used in connection with the removal of any obstruction to traffic;
- (e) The vehicle, if it cannot conveniently be used for such purpose in any other road, to be used in connection with any of the following operations, namely:
 - i) building, industrial or demolition operations;
 - ii) the removal of any obstructions to traffic;
 - iii) the maintenance, improvement or reconstruction of the said roads;
 - iv) the laying, erection, alteration, repair or cleaning of any sewer or of any main pipe or apparatus for the supply of gas, water or electricity, or of any telecommunications apparatus kept or installed for the purposes of a telecommunications code system or of any other telecommunications apparatus lawfully kept installed in any position.

(g) The vehicle if it cannot conveniently be used for such purpose in any other road to be used in the service of a local authority or water authority in pursuance of statutory powers or duties.

(h) the vehicle to be used by a universal service provider during the provision of a universal postal service for the purpose of delivering or collecting postal packets.

(i) vehicles used by the Fire Brigade, Police or Ambulance Service in carrying out their duties in or adjacent to a parking place.

Liability for a penalty charge

30. (a) If a vehicle (other than a vehicle otherwise exempted by this Order) is left during the operational hours in contravention of any provision of this Order a penalty charge shall be payable.

(b) In the case of a vehicle in respect of which a penalty charge is payable, a penalty charge notice may be issued by a Civil Enforcement Officer in uniform in accordance with The Civil Enforcement of Road Traffic Contraventions (Approved Devices, Charging Guidelines and General Provisions) (England) Regulations 2022.

Manner of payment of the penalty charge

31. The penalty charge shall be paid to Stevenage Borough Council in accordance with the instructions and within the time limits specified on the penalty charge notice.

Alteration of position of a vehicle in a parking place

32. Where any vehicle is standing in a parking place in contravention of the provisions of Article 30, a Police Constable in uniform or a Civil Enforcement Officer may cause to be altered the position of the vehicle in order that its position shall comply with those provisions.

Removal of a vehicle from a parking place

33. Where a Police Constable in uniform or a Civil Enforcement Officer is of the opinion that any of the provisions contained in Articles 6, 7, 8, 9, 17, 20 and 36 have been contravened or not complied with in respect of a vehicle left in a parking place he may cause the vehicle to be removed from the parking place and, where it is so removed, shall provide for the safe custody of the vehicle.

Movement of a vehicle in a parking place in an emergency

34. A Police Constable in uniform or a Civil Enforcement Officer may cause to be moved, in case of emergency, to any place he thinks fit any vehicle left in a parking place.

PART III – SUPPLEMENTARY PROVISIONS

Restrictions on the removal of Penalty Charge Notices

35. (a) Where a Penalty Charge Notice has been attached to a vehicle in accordance with the provisions of Article 25 no person other than the driver of the vehicle, a Civil Enforcement Officer or a Police Constable in uniform shall remove the Penalty Charge Notice from the vehicle unless authorised to do so by the driver of the vehicle.

(b) Provided that nothing herein shall apply to a Civil Enforcement Officer or a Police Constable in uniform or a person removing the vehicle in pursuance of an arrangement made by a Police Constable or a Civil Enforcement Officer by or under regulations in pursuance of powers contained in Sections 99, 100, 101 and 102 of the Road Traffic Regulation Act 1984.

Manner of standing in a parking place

36. Every vehicle left in a parking place in accordance with the foregoing provisions of this Order as shown in "the Off-Street Plans" shall stand in that parking place so that every part of the vehicle is within the marked limits of a parking bay.

Installation of and placing of traffic signs, bollards, charging devices, etc.

37. The Council shall:
- (a) Place and maintain traffic signs indicating the limits of each parking bay; and place and maintain in or in the vicinity of each parking bay as shown in "the Off Street Plans" traffic signs indicating that such parking place may be used during the operational hours for the leaving of the vehicles specified in Article 4; and
 - (b) Carry out such other work as is reasonably required for the purposes of the satisfactory operation of a parking place.

Other provisions

38. The driver of a vehicle shall not permit that vehicle to wait in a parking place unless the vehicle is licensed in pursuance of the provisions of the vehicle (Excise) Act 1971 and unless there is in relation to the use of the vehicle by the driver such a policy of insurance as complies with the requirements of Part VI of the Road Traffic Act 1972.
39. A driver shall always while their vehicle is in a parking place comply with any reasonable instruction given by a person authorised in that behalf by the Council.
40. Where in a parking place signs are erected or surface markings are laid for the purpose of:-
- (a) indicating the entrance to or exit from the parking place, or
 - (b) indicating that a vehicle using the parking place shall proceed in a specified direction within the parking place,
- no person shall drive or permit to be driven any vehicle unless with the permission of a person authorised by the Council (i) so that it enters the parking place otherwise than by an entrance, or leaves the parking place otherwise than by an exit, so indicated, or (ii) in a direction other than so specified.
41. No person shall, except with the permission of a person authorised by the Council in that behalf, drive or permit to be driven any vehicle in a parking place for any purpose other than for the purpose of leaving that vehicle in the parking place in accordance with the provisions of this Order and for the purposes of departing from the parking place.
42. The driver of a vehicle using a parking place is not permitted to drive any vehicle without due care and consideration or in a manner likely to endanger any other person.
43. No person shall drive or ride (otherwise than in a side car) on a motor cycle in a parking place without wearing protective headgear within the meaning of the Motor Cycles (Protective Helmets) Regulations 1980 PROVIDED that this Article shall not apply to any person driving or riding on a motorcycle in any of the circumstances mentioned in Regulation 4(2) of those Regulations.

44. Any person using a parking place as a means of passage proceeding from one road to another road or for access purposes to property or land adjacent to but not forming any part of the parking place shall be deemed to be so using by licence of the Council and not as of right.
45. If at any time in or on a parking place or places or in any position adjacent thereto a particular space or spaces is or are reserved by means of a sign or surface marking for the use of any person or category of persons authorised by the Council or for the leaving of motorcycles, no person shall leave a vehicle in any such parking space other than for the purpose specified.
46. The Council does not undertake to supervise the parking places shown on plans listed in Schedule 1 to this Order and entry to and exit from and use of these parking places is entirely at the users risk and although the Council, its servants or agents do not attempt to exempt themselves from their common law duty of reasonable skill and care or their obligations under the Occupiers Liability Acts 1957 and 1984 the Council, its servants and agents do not accept liability for any damage to or loss of vehicles or their contents which arise from acts or omissions outside their reasonable control.
47. A driver of a vehicle shall not use a parking place so as unreasonably to prevent access to any premises adjoining the parking place or so as to be a nuisance to the Council or the owners or occupiers of any adjoining property or to any person using the parking place.
48. No person shall in a parking place light or cause to permit to be lit any fire.
49. No person shall deposit in a parking place any vehicles, goods equipment, matter or materials so as to obstruct any part of a parking place without the prior written consent of the Council.
50. No person shall remove, injure or in any way interfere with any barrier or machinery whether moveable or immovable, or any sign or equipment in a parking place unless so authorised by a person authorised in that behalf by the Council.
51. No person shall wilfully, carelessly or negligently deface, injure, damage or destroy any part of a parking place or any wall, fence or marking, sign, fitting or equipment in or on a parking place.
52. A driver shall not abandon a vehicle in a parking place.
53. If it appears to the Council that a vehicle has been abandoned, the Council may sell or otherwise dispose of the vehicle provided the power of disposal conferred by this Article shall not be exercisable unless there have been taken by the Council such of the relevant steps as are required to be taken by it in exercising its powers to remove abandoned vehicles contained in the Refuse Disposal (Amenity) Act 1974.
54. Any person using a parking place shall not cause or suffer any dog belonging to him or in his charge to enter or remain in a parking place unless such dog be and continues to be on a lead and under proper control and effectively restricted from causing annoyance to any person and from worrying or disturbing any animal or is effectively confined within the vehicle.
55. The restrictions imposed by this Order shall be in addition to and not in derogation from any restriction or requirement imposed by any other regulations made or having effect as if made under the Act of 1984 or by or under any other enactment.

Schedule 1: The Borough of Stevenage (Railway North Car Park, Stevenage) (Off-Street Parking Places) Order Plans 2023

Plan number	TPE/03/22-9/01
Plan number	TPE/03/22-9/02
Plan number	TPE/03/22-9/03
Plan number	TPE/03/22-9/04
Plan number	TPE/03/22-9/05
Plan number	TPE/03/22-9/06
Plan number	TPE/03/22-9/07

Schedule 2: charges payable for parking

Name of car park / Street of car park	Days and times	Maximum period of stay	Amount payable
1. Railway North Car Park / Lytton Way	Monday to Friday between 4am on one day and 4am on the next day	Any duration	£10.00
	4am on Saturday to 4am on Sunday	Any duration	£8.00
	4am on Sunday to 4am on Monday	Any duration	£7.50
	At any time	Charge for monthly season ticket	£169
	At any time	Charge for lost / damaged season ticket	£36
	At any time	Charge for suspending a season ticket for a period of no more than six months	£36
	At any time	Charge for blue badge holder's yearly season ticket	£52.50
	At any time	Charges for a motorcycle which is left in a motorcycle parking bay	£0.00

IN WITNESS whereof the Common Seal of Stevenage Borough Council was hereunto affixed this 27th day of April 2023.

The Common Seal of
Stevenage Borough Council
was hereunto affixed
in the presence of:-

 Authorised signatory



IN WITNESS whereof the Common Seal of Stevenage Borough Council was hereunto affixed this day of 2023.

The Common Seal of () Stevenage Borough Council) was hereunto affixed) in the presence of:- ()

.....Authorised signatory



Thom *AD*

KEY:

- ☐ Long and short stay parking bay
- ☐ Disabled parking bay
- ☐ Electric vehicle parking bay

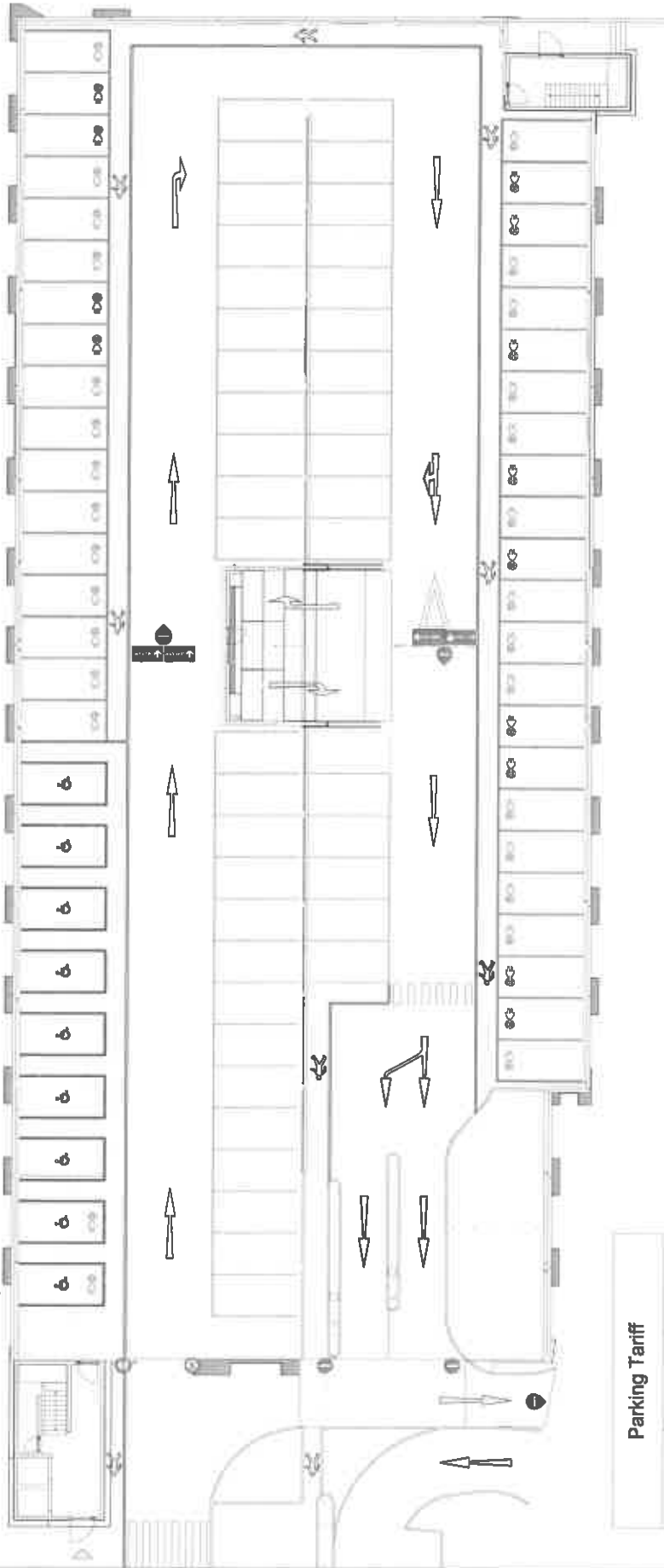

Parking Tariff

Days and times	Maximum period of stay	Amount payable
Monday to Friday between 4am on one day and 4am on the next day	Any duration	£10
Saturday to Sunday 4am on Sunday to 4am on Monday	Any duration	£8
Monday to Friday 4am on Monday to 4am on Tuesday	Any duration	£7.50

Stevenage
BOROUGH COUNCIL

255 VERNON ROAD, STEVENAGE, HERTS SG1 2JG
Tel: 01438 844444
Fax: 01438 844445
Email: enquiries@stevenage.gov.uk
Website: www.stevenage.gov.uk

The Borough of Stevenage
(Stevenage) (Off-Street
Parking Places) Order 2023

DRAWING: Railway North
Car Park Ground
Floor
Date: 14-12-2022
Scale: 1:250 at A3
Drawing No: TPE/03/22-902

IN WITNESS whereof the Common Seal of Stevenage Borough Council was hereunto affixed this day of 2023.

The Common Seal of Stevenage Borough Council was hereunto affixed in the presence of:-

Paul May

Authorised signatory



KEY:

- Long and short stay parking bay
- Disabled parking bay
- Electric vehicle parking bay

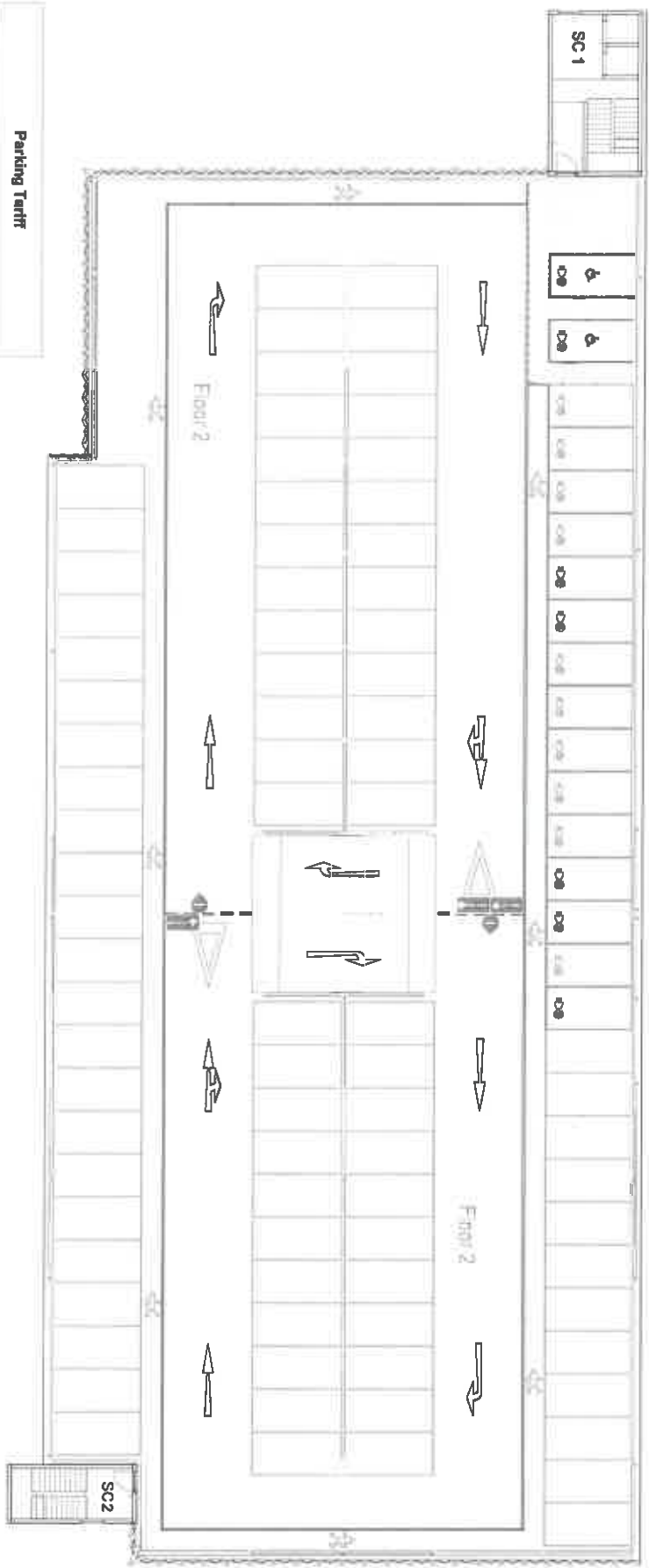

Parking Tariff		
Days and times	Maximum period of stay	Amount payable
Monday to Friday between 4am on one day and 4am on the next day	Any duration	£10
to 4am on Saturday	Any duration	£8
Sunday to 4am on Monday	Any duration	£7.50

IN WITNESS whereof the Common Seal of
Stevenage Borough Council was
hereunto affixed this day of 2023.

The Common Seal of
Stevenage Borough Council
was hereunto affixed
in the presence of:-
..... Authorised
signatory

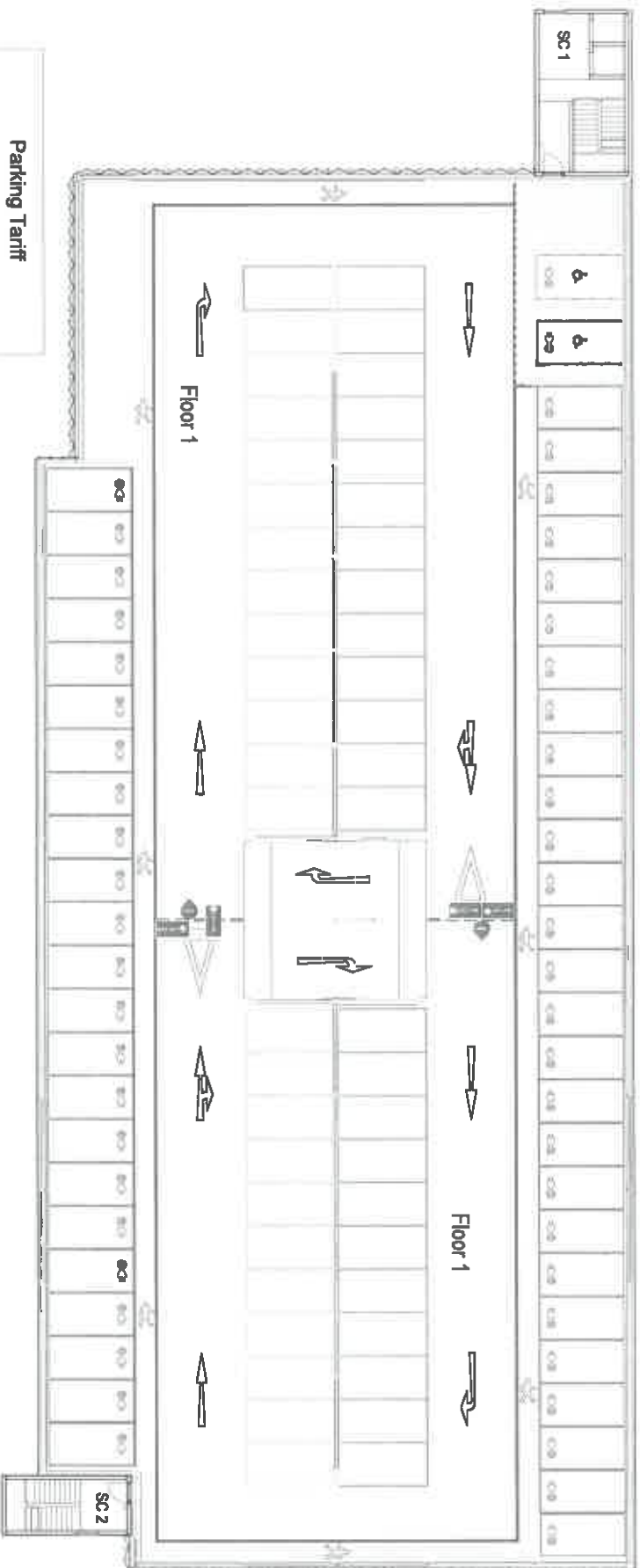

Parking Tariff		
Days and times	Maximum period of stay	Amount payable
Monday to Friday between 4am on one day and 4am on the next day	Any duration	£10
4am on Saturday to 4am on Sunday	Any duration	£8
4am on Sunday to 4am on Monday	Any duration	£7.50

have the

KEY:

- ☐ Long and short stay parking bay
- ☒ Disabled parking bay
- ☐ Electric vehicle parking bay

Stevenage
BOROUGH COUNCIL

STEVENAGE BOROUGH COUNCIL
2nd Floor
Stevenage Town Hall
100, High Street
Stevenage, Herts SG1 1JH
Tel: 01438 551100
Fax: 01438 551100

The Borough of Stevenage
(Stevenage) (Car-Street
Parking Prices) Order 2023

Drawn by
RPS
Checked
LA

14-12-2022

1250 at A3

TPE0322-903

IN WITNESS whereof the Common Seal of
Stevenage Borough Council was
hereunto affixed this day of 2023.

The Common Seal of
Stevenage Borough Council
was hereunto affixed
in the presence of:-

..... Authorised
signature

Mr. [unclear]



KEY:

Long and short
stay parking bay

Disabled parking
bay

Electric vehicle
parking bay

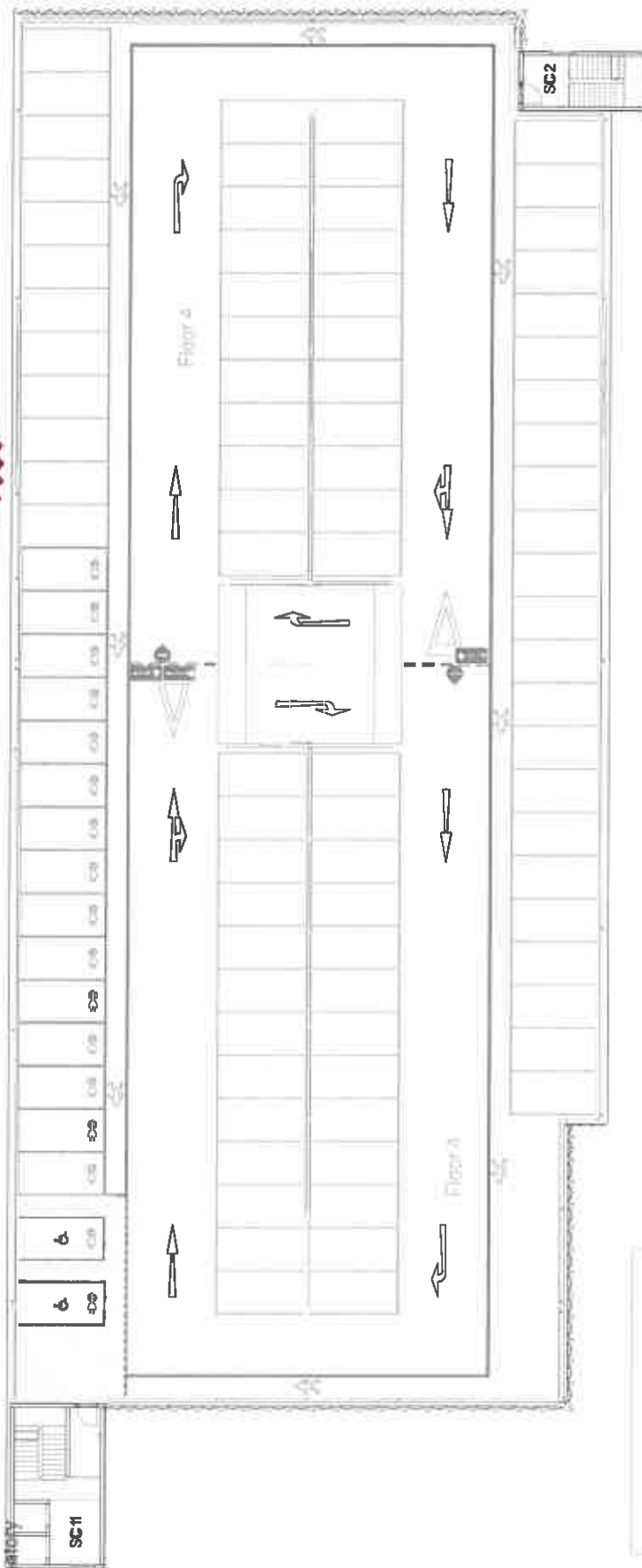

Parking Tariff		
Days and times	Maximum period of stay	Amount payable
Monday to Friday between 4am on one day and 4am on the next day	Any duration	£10
4am on Saturday to 4am on Sunday	Any duration	£8
4am on Sunday to 4am on Monday	Any duration	£7.50

Stevenage
BOROUGH COUNCIL

STEVENAGE 5
Zayed Al-Jawad
Assistant Direct
Planning & Reg
Danehill House
Danehill
Stevensage,
Herts, SG1 1HN
Telephone: 01438 764000

**The Borough of Stevenage
(Stevenage) (Off-Street
Parking Places) Order 2023**

Railway North Car Park
Fourth Floor

1000

1000

14-12-2022

SCALE:



IN WITNESS whereof the Common Seal of
Stevenage Borough Council was
hereunto affixed this day of 2023.

True
file

The Common Seal of
Stevenage Borough Council
was hereunto affixed
in the presence of:-
..... Authorised
signatory

KEY:

- ☐ Long and short
stay parking bay
- ☒ Disabled parking
bay
- ☒ Electric vehicle
parking bay

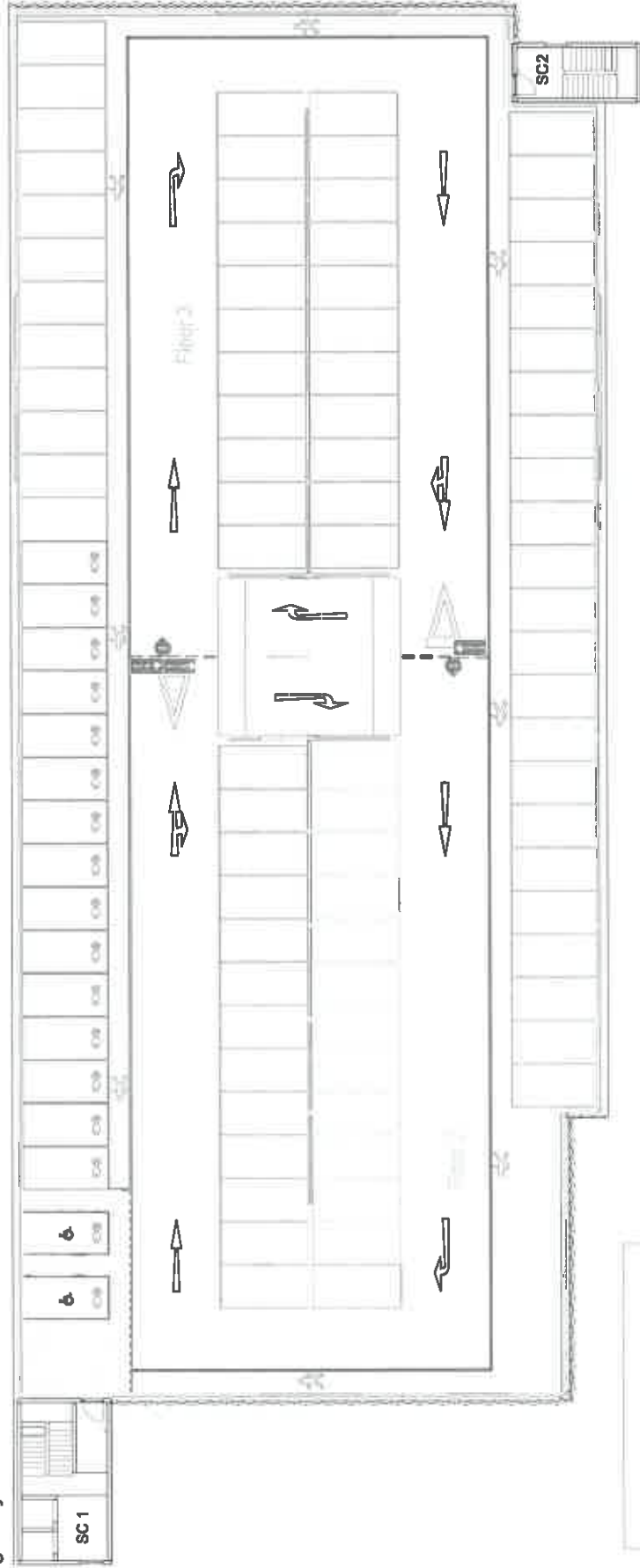

Stevenage
BOROUGH COUNCIL

STEVENAGE BOROUGH COUNCIL
COUNCIL CHAMBERS
100-102, THE ARCADE
STEVENAGE, HERTS SG1 1AA
Tel: 01438 831111
Fax: 01438 831111

The Borough of Stevenage
(Stevenage) (Off-Street
Parking Places) Order 2023

STEVENAGE
Railway North Car Park
Third Floor

DRAWN BY RPS	DATE 14-12-2022	SCALE 1:250 at A3
TPE/0322-805		

Parking Tariff		
Days and times	Maximum period of stay	Amount payable
Monday to Friday between 4am on one day and 4am on the next day	Any duration	£10
4am on Saturday to 4am on Sunday	Any duration	£8
4am on Sunday to 4am on Monday	Any duration	£7.50

IN WITNESS whereof the Common Seal of
Stevenage Borough Council was
hereunto affixed this day of 2023.

The Common Seal of
Stevenage Borough Council
was hereunto affixed
in the presence of:- Authorised
signatory



Handwritten signature

KEY:

- ☐ Long and short stay parking bay
- ☐ Disabled parking bay
- ☐ Electric vehicle parking bay

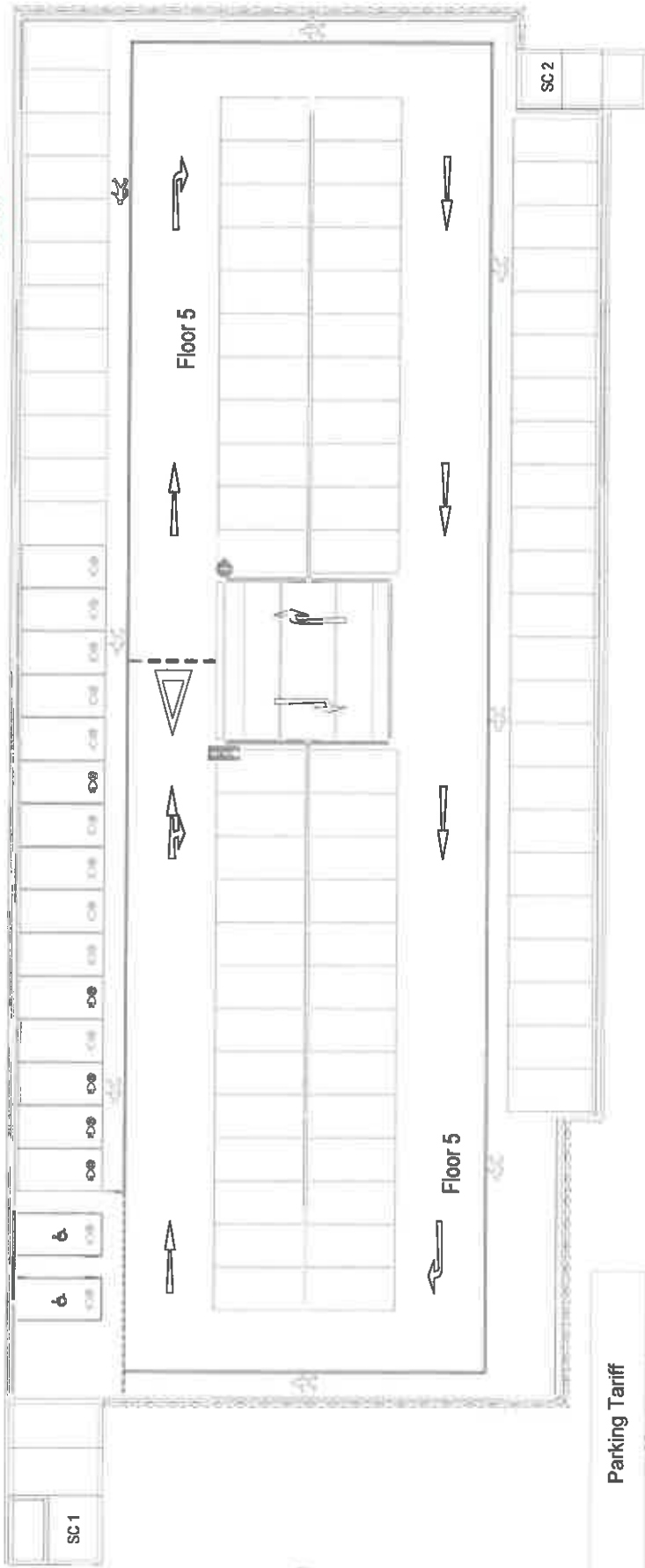

Stevenage
BOROUGH COUNCIL

STEVENAGE BOROUGH COUNCIL
Council Offices
100-102 Church Street
Stevenage, Herts SG1 1JH
Tel: 01438 555555
Fax: 01438 555556
Email: enquiries@stevenage.gov.uk

The Borough of Stevenage
(Stevenage) (Off-Street
Parking Places) Order 2023

Stevenage
Railway North Car Park Fifth
Floor

DATE	14-12-2022
TIME	1:1250 at A3
LOCATION	TPE/03/22-9/07

Parking Tariff		
Days and times	Maximum period of stay	Amount payable
Monday to Friday between 4am on one day and 4am on the next day	Any duration	£10
4am on Saturday to 4am on Sunday	Any duration	£8
4am on Sunday to 4am on Monday	Any duration	£7.50

